

DIRECT READING IRON LOSS TESTER

DAC-IR-3



DAC-IR-3 is a measuring instrument that can easily measure the iron loss of a single sheet. The grade of the sheet can be quickly determined by placing the measuring probe on the sheet.

Test Specimens

Electromagnetic Steel Sheet
(Non-Oriented and Grain-Oriented Core)

Features

- Measures core Loss in W/kg or W/lb of a single sheet sample.
- Easy and quickly measure the core loss of G.O and N.G.O samples.
- Simply input thickness and select flux density (1T, 1.5T, 1.7T) to automatically adjust the flux density and read the core loss directly.
- Can be controlled via PC through RS232C Interface.
- Optional thermal printer for printing measured results.

Principle

DAC-IR-3 has a built-in U-shaped yoke integrated into the measuring probe. An exciting coil and a magnetic flux detection coil are wound around the U-shaped yoke, and the magnetic path is formed by placing the yoke on a steel sheet.

The core loss of the sample sheet is calculated from the current flowing through the exciting coil and the voltage generated in the magnetic flux detection coil.

DAC-IR-3 can easily determine the grade of the sample sheet that is closely coincident with data obtained by Epstein Method.

Model DAC-IR-3 DIRECT READING IRON LOSS TESTER

Specifications

Specimen	Electromagnetic Steel Sheets (Grain-Oriented [GO], Non-Grain-Oriented [NGO] cores)
Thickness range	0.05 – 0.90 mm
Measuring core loss range	0.10 – 19.99 W/kg 0.045 – 9.000 W/lb
Flux Density	1T, 1.5T, 1.7T
Accuracy	±5%
Frequency	50/60Hz (Synchronized to power supply frequency)
Input Power	AC 100V – 240V
Size and Weight	W189 x H103 x D287mm, Approx. 5.0kg
Optional item	Thermal Printer (BL2-58SNWJC-SK) W93xD125xH70mm Approx. 265g

Components

Main Unit	-----	1 unit
Reference Sheets (GO&NGO)	-----	1 each
Standard probe	-----	1 pc
Small probe	-----	1 pc
Probe Lead	-----	1 pc
AC Cord	-----	1 pc



Optional Thermal Printer
Model BL2-58SNWJC-SK

REMARKS:

SOKEN DAC-IR-3 is a single strip measuring instrument that can evaluate iron loss in the electromagnetic steel sheet comparable to the Epstein Frame Test method.

Recommended conditions for accurate measurement are as follows.

- 1) Test samples should be 40mm×40mm or large.^(*)
- 2) A flat sheet without warping, twisting, or shear deformation should be used.
- 3) Measure multiple samples, and take the average.

^{*}1 Smaller specimens can be measured with the small probe. With either probe, sample sheets smaller than the core area cannot be measured.

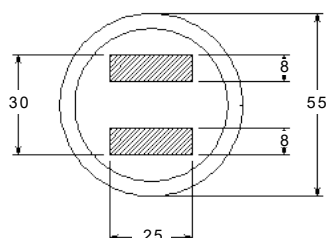

Standard Probe

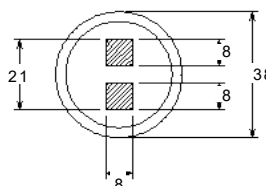

Small Probe



March 2025

SOKEN

1-34-22, TOBITAKYU
CHOFU, TOKYO 182-0036
JAPAN

TEL: 81 42 490 6929 (Export Dept)
FAX: 81 42 490 6807
www.soken-jp.com

